



Setup IMAP Email Service for Android

If you would like to learn more about the differences between POP and IMAP, please see the POP vs IMAP guide

To set up Android for IMAP, do the following:

1. From the Home screen, tap the Application button and then tap the **Email** icon.
2. If this is your first email account, you will be presented with an email setup screen, tap the **Next** button. Otherwise, press the **Menu** button, tap **Accounts**, press the **Menu** button, and tap **Add account**.
3. Enter your entire email address (e.g., myname@mydomain.com) and in the second box, enter the password associated with your email account.
4. Tap the **Manual setup** button and then tap the **IMAP** button and enter the following information in the fields provided:
 - Username—Enter your entire email address (e.g., myname@mydomain.com).
 - Password—Enter the password associated with your email account.
 - IMAP server—Enter the secure server name: **secure.emailsrvr.com**
 - Port—Enter the secure port number: **993**
 - Security type—Select **SSL (always)**.

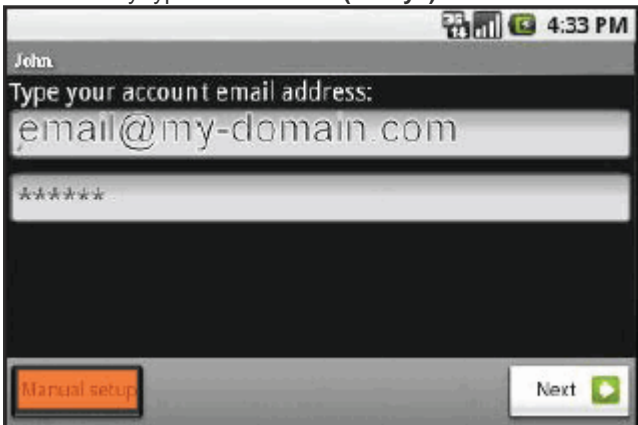

7. Tap the **Next** button. The device will connect to the internet and check your incoming settings.
8. On the **Outgoing server settings** screen, enter the following information in the fields provided:
 - SMTP server—Enter the secure server name: **secure.emailsrvr.com**
 - Port—Enter the secure port number: **465**
 - Security type—Select **SSL (always)**
9. Tap the **Require sign-in** checkbox then tap the **Next** button and the device will connect to the internet and check your outgoing settings.

Note: On the **Account options** screen, make changes, as desired.

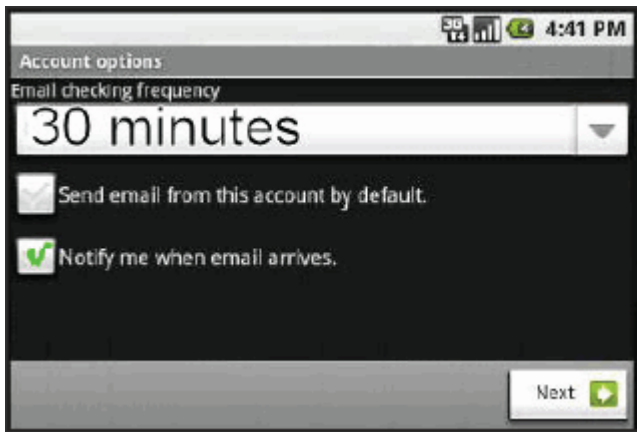

10. Tap the **Next** button. On the **Set up email** screen, enter your name in the **Type your name** field (this is the name that will be displayed in the **From** field of email messages you send) and then tap the **Done** button.